

CROWD PLEASER

Breakfast for two or for 20 is no problem in a kitchen designed for everyday living.

writer JAN SOULTS WALKER
photographer KIMBERLY GAVIN
field editor ELAINE ST. LOUIS



European white oak flooring, made up of substantial 16-inch-wide planks, warms the kitchen and visually unites the serving area with the work core.



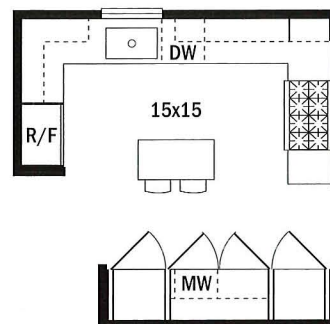

magical. Contemporary. Cottage. “Those are the three words the homeowners gave me

to help envision their ideal kitchen” for this home in Vail, Colorado, says kitchen designer Carolyn Samelson. A placid waterfront location in the quaint ski town instantly qualified the house as magical, but it was up to Samelson and her design teammates, architect Beth Levine and interior designers Jim Powell and Suzie Page, to integrate contemporary and cottage-style features.

“The owners wanted the look to be clean and simple to set off antique and retro-modern elements,” Powell says. But successfully merging disparate characteristics to create cohesive style was only half the challenge. The 15×15-foot kitchen also needed to accommodate large-scale entertaining for overnight guests filtering through in the mornings for coffee and a quick breakfast before hitting the slopes.



OPPOSITE TOP: At the sink, a high-arc faucet pairs with a secondary spout that delivers both filtered and hot water. **OPPOSITE BOTTOM:** Open shelves take advantage of a corner near the range, offering quick access to serving pieces and cookbooks. **THIS PHOTO:** Lighted glass-front cabinets make the dishware on display easy to locate. The slender Parsons-style table's cool marble top is ideal for rolling out dough.



LEFT: Beside the range, this pullout keeps clutter off the countertops with its dedicated spots for utensils, knives, and cooking ingredients—all in a slim 10-inch-wide space. **BELOW LEFT:** Rectangular sconces with linen shades lend a modern look and cast a soft, filtered glow. **OPPOSITE:** Equipped with a coffee bar, microwave oven, and warming drawer, the serving center easily feeds a crowd as visitors pass through the kitchen on the way to the dining room.

The secret to hosting these crowds sits inside a deep wall of cabinetry. Behind sleek doors that open and slide back into the wall, a well-stocked breakfast center waits to serve guests. The rich gray-blue color was chosen so that the cabinets, which can be seen from the home's entryway, virtually disappear as the eye travels through the kitchen to the beautiful river view from the adjoining dining room.

Buttressing the serving wall, a U-shape work core clad in white keeps the look light and airy, with two different—but very simple—cabinet door styles for subtle interest. “We really liked the simplicity of the white cabinets with the white quartz countertops, so we continued the quartz on the backsplash, even carrying the material to the ceiling behind the range,” Powell says.

The blue French-made range stands out against the white, exuding an abundance of retro-modern charm. A similar hue appears on the long legs supporting a small island—a nod to farmhouse table styling. “A traditional island would have introduced too much mass into the space,” Powell says.

The island helps route breakfast crowds away from the work core. But it also offers a friendly spot to sit and chat with the cook—especially as people leisurely stop by the breakfast center for coffee and a bite to eat. “It’s really rewarding knowing that there is a place for everything and everyone in this kitchen—whether it’s just the couple or a crowd,” Samelson says. **KBI**

RESOURCES BEGIN ON PAGE 138.





bright idea

Use contrasting cabinetry finishes to distinguish adjacent spaces. Stick to all cool or all warm tones for a unified look.



114-119 CROWD PLEASER

Kitchen designer—Carolyn Samelson, CKD, ASID, WMOBS; 970/390-9155; wmobs.com.
Architect—Beth Levine, Beth Levine Architect, Inc.; 970/376-4736; bethlevinearchitect.com.
Builder—Kevin O'Donnell, Beck Building Co.; 970/949-1800; beckbuilds.com.
Interior designers—Jim Powell, J. Powell and Associates, Inc.; 970/748-0383; jpowell.net, and Suzy Page, Twenty Three 07; 512/477-2307; twentythree07.com.
Range CornuFé 110 in Provence Blue—La Cornue; 800/457-1356; lacornueusa.com.
Vent hood KD122250.OE-UL—Küppersbusch; kuppertsbuschusa.com.
Refrigerator 736 TCI—Sub-Zero, Inc.; 800/222-7820; subzero.com.
Dishwasher SHV68E13UC—Bosch; 800/944-2904; boschappliances.com.
Cabinetry custom—William Ohs, Inc.; 303/371-6550; wmohs.com.
Backsplash, countertops CaesarStone in White—CaesarStone US; 877/978-2789; caesarstoneus.com.
Sink stainless—Franke Kitchen Systems Division; 800/626-5771; frankeksd.com.
Faucet, water dispenser Tara Ultra—Dornbracht USA, Inc.; 800/774-1181; dornbracht.com.
Flooring white oak—check with local suppliers.
Sconces Estudio Estiluz Miris Vertical Wall Sconce A-2811—Y Lighting; 866/428-9289; y-lighting.com.
Kitchen table Parsons in custom finish, **marble top** Vernatino—Room & Board; 800/486-6554; roomandboard.com.
Counter stools Bertolia Barstool—Knoll; 800/343-5665; knoll.com.

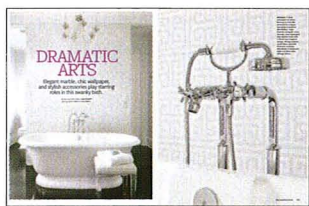

120-123 DRAMATIC ARTS

Architect—Timothy S. Adams, T.S. Adams Studio, Architects, Inc.; 404/262-3499; tsadamsstudio.com.
Interior design—Traci Rhoads, Allied ASID, Traci Rhoads Interiors; 404/307-1235; trinteriors.net.
Tub, bath and shower fixtures, sinks, faucets—Kohler Co.; 800/456-4537; us.kohler.com.
Cabinetry—Cabinet Resources; 770/935-8810; cabinetresources.com.
Cabinetry hardware—Restoration Hardware; 800/910-9836; restorationhardware.com.
Countertop, shower tiles Carrara marble—Ceramic Technics LTD; 770/740-0050; ceramictechnics.com.
Lighting: over tub—Circa Lighting; 877/762-2323; circa-lighting.com, and **vanity sconces**—Waterworks; 800/998-2284; waterworks.com.
Wallpaper—Jonathan Adler; 800/963-0891; jonathanadler.com.
Mirrors—Mirror Image Home; 323/869-1700; mirrorimagehome.com.
Stool in Lucite—Global Views; 888/956-0030; globalviews.com.



124-129 MATERIALS MATTER

Interior designer—Suzanne Biers Harrington, The Suzanne Biers Company; 602/999-1550; sbiers.com.
Builder—Dick Lloyd, Dick Lloyd Custom Homes, Inc.; 480/585-2466; dicklloydhomes.com.
Tub, tub faucet, sink faucet, vanity countertop, cabinetry hardware—Clyde Hardware Co., Inc.; 602/264-2106; clydehardware.com.
Shower door glass, mirrors—Cohaco Building Specialties; 623/247-5121; cohaco.com.
Shower wall tiles, wood-grain tiles, pebbles—Daltile; 800/933-8453; daltile.com.
Cabinetry, window treatment, teak stool—The Suzanne Biers Company; 602/999-1550; sbiers.com.
White tray—West Elm; 866/428-6468; westelm.com (product line varies).
White vase, back scrubber—HomeGoods; 800/614-4663; homegoods.com (product line varies).
Bubble bath, bath salts, bath milk, sponge—Restoration Hardware; 800/910-9836; restorationhardware.com.
Shell starburst—Z-Gallerie; 800/908-6748; zgallerie.com.
Shampoo, conditioner Fekkai—Ultra Beauty; ultra.com.